

## F1 Fixing at end bearing.

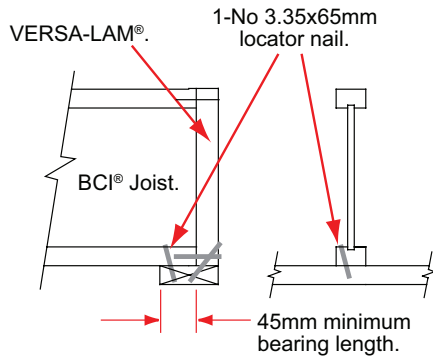

Note: To avoid splitting flange, start locator nail at least 38mm from end. Nails will need to be driven at an angle to prevent splitting of bearing plate.

## F1a Party wall end bearing.

For alternative detail, see F4a

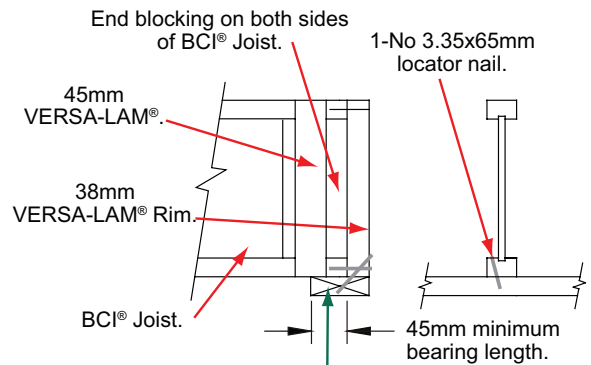

Note: To avoid splitting flange, start locator nail at least 38mm from end. Nails will need to be driven at an angle to prevent splitting of bearing plate.

## F2 BCI® Rim blocking.

Note: Nail BCI® rim blocking to wallplate using 3.35x65mm nails each side at 300mm centres. Skew nail top of blocking to joist.

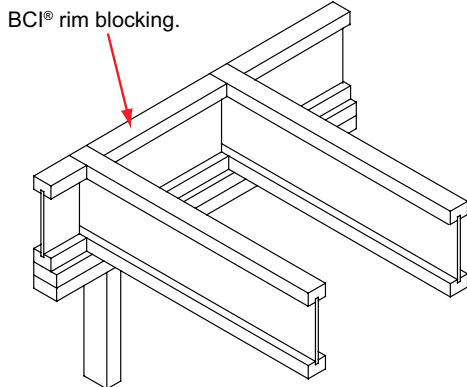

## F3a Non load-bearing stud wall (perpendicular to joist).

Perpendicular non load-bearing stud wall.

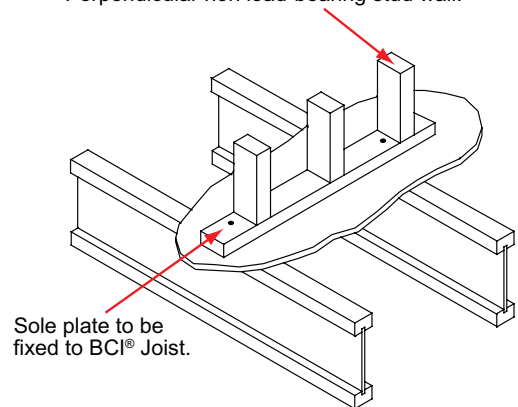

## F4 VERSA-LAM® Rim (perpendicular to joist - external wall).

Note: Nail VERSA-LAM® rim board to BCI® Joists with 2-No 3.35x65mm nails, one at the top and one at the bottom (see detail F1).

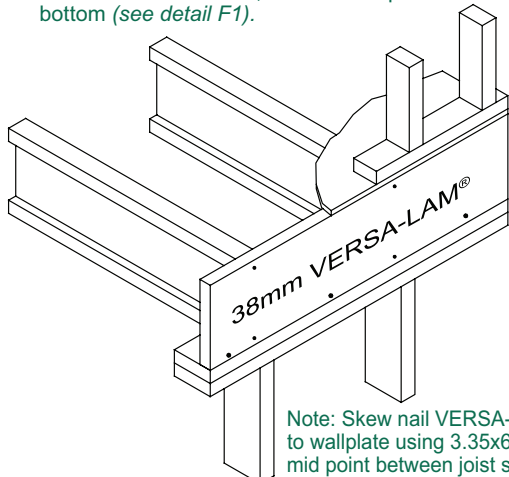

Note: Skew nail VERSA-LAM® rim board to wallplate using 3.35x65mm nails at mid point between joist spacings.

## F4a VERSA-LAM® Rim (perpendicular to joist - party wall).

